

CONSTRUCT BACKING BLOCK FOLLOWING PIPE INSTALLATION AS FOLLOWS:-
 - SIDES OF CUT CONCRETE TO BE SCABBLED
 - SCABBLED CONCRETE & PIPE BARREL TO BE FREE OF DUST AND GREASE
 - A COATING OF EPIREZ 633 EPOXY MORTAR BINDER TO BE APPLIED TO ALL SURFACES TO BE IN CONTACT WITH NEW CONCRETE IMMEDIATELY PRIOR TO CONCRETE PLACEMENT

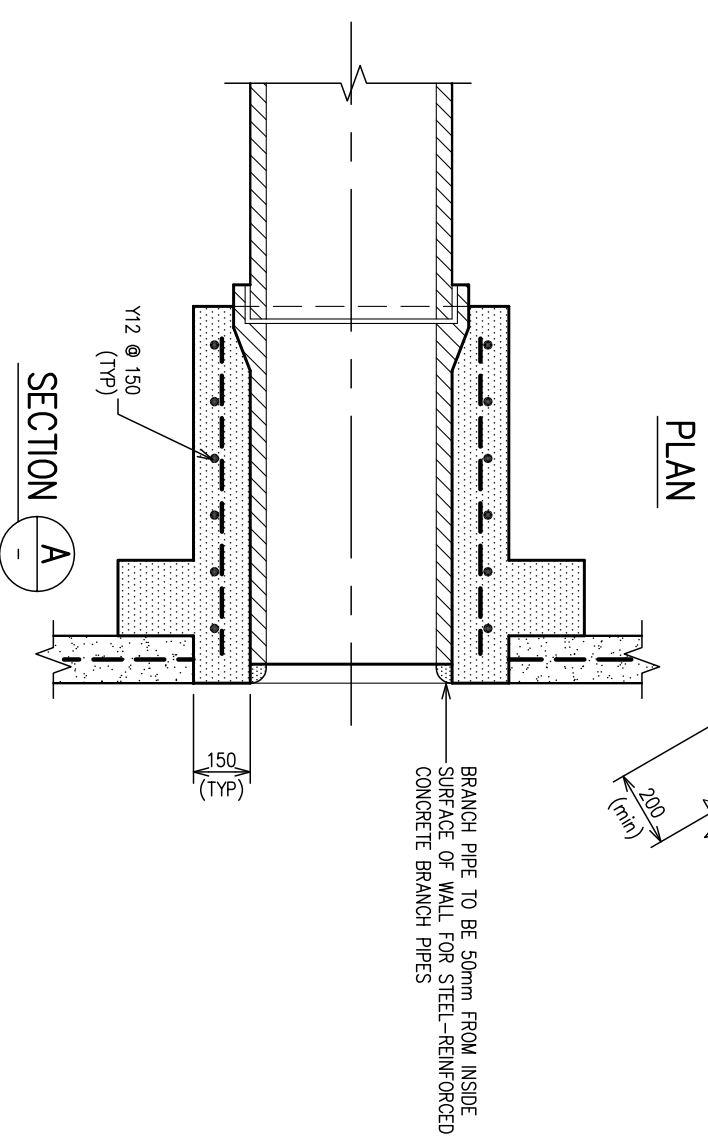

- NOTES:**
1. APPROVAL TO CONNECT TO A HUNTER WATER CORPORATION STORMWATER ASSET IS CONDITIONAL ON THE RELEVANT LOCAL COUNCIL REVIEWING AND APPROVING INTERNAL STORMWATER DRAINAGE DESIGNS. SUCH APPROVAL MUST BE EVIDENCED TO HUNTER WATER PRIOR TO GRANTING APPROVAL TO CONNECT TO HWC STORMWATER SYSTEMS.
 2. HYDRAULIC DISTURBANCE AND SMOOTH INTEGRATION OF FLOW IN THE STORMWATER SYSTEM ARE TO BE CONSIDERED FOR ALL CONNECTIONS. IN GENERAL ALL CONNECTIONS SHOULD BE MADE AT A MAXIMUM ENTRANCE OF 45° TO THE MAIN CULVERT FLOW.
 3. THIS STANDARD CONSTRUCTION PRACTICE DRAWING APPLIES ONLY TO CONNECTIONS WHERE THE INCOMING PIPE IS NOT GREATER THAN 300MM IN DIAMETER
 4. IF INTERNAL ACCESS TO THE CULVERT IS UNAVAILABLE THE BRANCH PIPE CONNECTED TO THE CULVERT IS TO BE SHORT ENOUGH TO ALLOW ADEQUATE REPAIRS TO THE INSIDE OF THE CULVERT THROUGH THE BRANCH PIPE.

REV. N°	REVISION	APPROVED	DATE

HUNTER WATER CORPORATION
 A.C.N. 053 102 837

APPROVED: **MANAGER** PLANNING AND DEVELOPMENT

APPROVED: **MANAGER** CONSTRUCTING ENGINEERS

APPROVED: **MANAGER** PLANNING AND DEVELOPMENT

STANDARD CONSTRUCTION PRACTICE DRAINAGE STANDARD

STANDARD METHOD FOR PIPE CONNECTIONS TO STORMWATER CULVERTS