

SECTIONAL ELEVATION ON PUMPING STATION

TO BE USED IN ROCK FOUNDATIONS AND OPEN CUT CONSTRUCTION

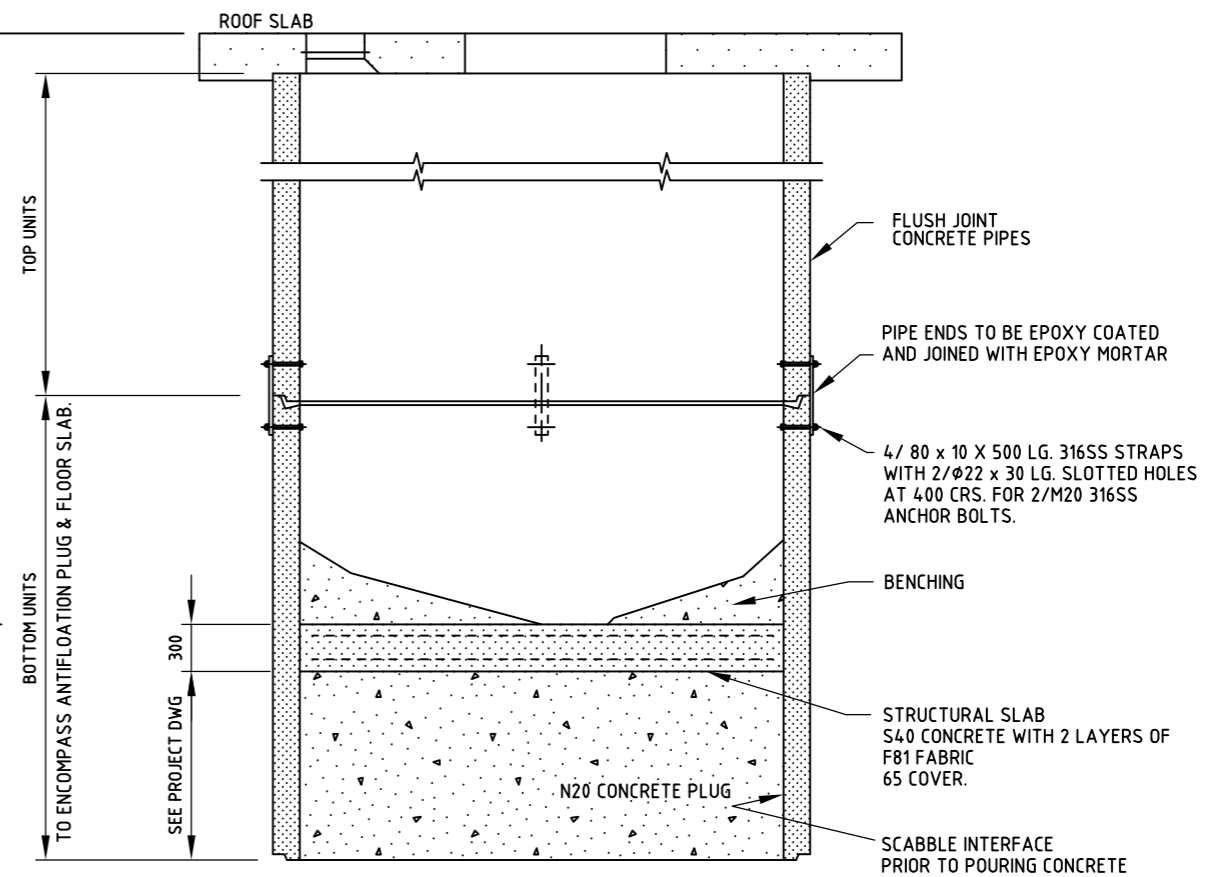

SECTIONAL ELEVATION ON PUMPING STATION

TO BE USED WHERE PRECAST UNITS ARE TO BE SUNK AS CAISSON

FLUSH JOINT CONCRETE PIPES					
MANUFACTURER	PUMP WELL DN	ACTUAL OUTSIDE DIA.	MINIMUM WALL THICKNESS	MAXIMUM UNIT LENGTH	CONCRETE REQUIREMENTS
HUMES	1800	2005	115	2440	MINIMUM CEMENT CONTENT 400 kg/cu.m MAXIMUM W/C BY MASS 0.45 CEMENT TYPE SR MINIMUM GRADE 32 MPa
	2100	2388	125		
	2400	2718	135		
	2700	3030	160		
	3000	3410	170		
ROCLA	1800	2019	114		
	2100	2336	135		
	2400	2718	140		
	2700	2980	140		
	3000	3310	155		

NOTES:

- THIS DRAWING IS TO READ IN CONJUNCTION WITH THE RELEVANT PUMPING STATION PROJECT DRAWINGS.
- INLET AND OUTLET PIPES ARE NOT TO PASS THROUGH WALL UNIT JOINTS.
- PRECAST UNITS ARE TO BE DESIGNED FOR EXTERNAL FLUID DENSITY OF 15kN/M²
- THE WEIGHT OF THE CAISSON WALL AND CONCRETE PLUG IS TO RESIST BOUYANT FORCE DUE TO EXTERNAL WATER LEVEL AT TOP OF CAISSON WALL.
- THE MANUFACTURER IS RESPONSIBLE FOR THE DESIGN OF THE PRECAST UNITS FOR HANDLING AND TRANSPORTATION LOADS.
- PRECAST UNITS ARE TO BE CLEARLY LABELLED "TOP UNIT" OR "BOTTOM UNIT" BY THE MANUFACTURER.
- INTERNAL SURFACE FINISH OF PRECAST UNITS TO BE TO AS 3610 CLASS 1.

1	CONCRETE HOB REMOVED FROM WET-WELL OPENING. HOB STILL REQUIRED FOR SLIDING COVER ARRANGEMENT.	S.H.	1/06/2016
REV. N°	REVISION	APPROV	DATE
APPROVED		APPROVED	
© COPYRIGHT HUNTER WATER CORPORATION		MANAGER ASSET MANAGEMENT	



STANDARD CONSTRUCTION PRACTICE
SEWERAGE STANDARD
 SEWAGE PUMPING STATIONS
 DN 1800 TO DN 3000 PRECAST TYPE PUMP WELL
 DETAILS

CAD FILE NAME: SCP-900

SCP-900

ISSUED: 2016

A3